



Lymore Gardens,

Asking Price £365,000

FOR SALE



- Two Double Bedrooms
- Two Reception Rooms
- Spacious
- Mid-Terrace
- Good Size Garden

THE PROPERTY

Vendors Comments: We originally moved here over 50 years ago into a community and we are still living within that community now. We were drawn to the area due to its proximity to the local shops, town centre and Oldfield Park train station. We raised a family here and have a huge amount of happy memories. The play park at the end of the street was a fantastic bonus along with the wonderful and walkable local schools. We are now much older and looking to move to a bungalow due to health and age related issues. We hope you will love this house and home as much as we have

Ideally positioned, just a short distance from Oldfield Park railway station, the property benefits from excellent transport links into the city centre and beyond. This is a well proportioned two-bedroom home on Lymore Gardens, which offers spacious accommodation across two floors.

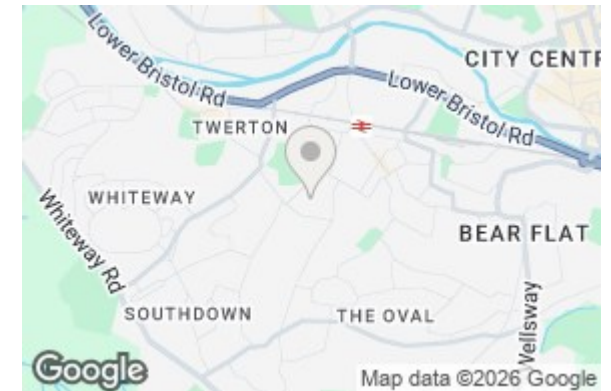
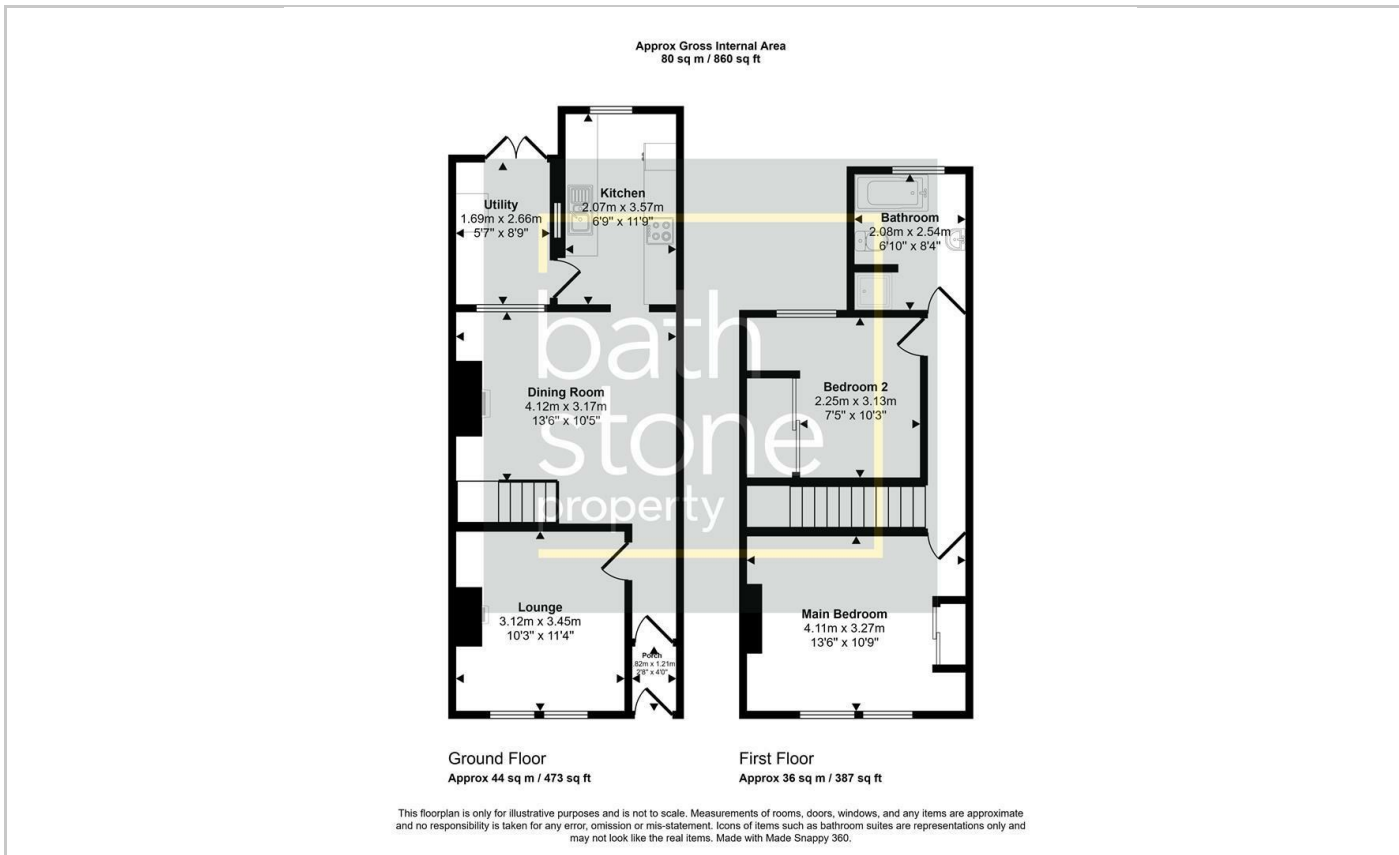

Energy Efficiency Rating		Current	Potential
Very energy efficient - lower running costs			
(92 plus) A			
(81-91) B			
(69-80) C			
(55-68) D			
(39-54) E			
(21-38) F			
(1-20) G			
Not energy efficient - higher running costs			
England & Wales		EU Directive 2002/91/EC	